

Tyler/Union

Union-Tite Ductile Iron Compact Fittings SUBMITTAL

SIZES:	4" through 24"
STANDARDS:	ANSI/AWWA C153/A21.53
PRESSURE RATING:	350 PSI; Except for Wyes and Flanged branch fittings
NSF-61:	Meets all requirements, UL Certified
COATING:	ANSI/AWWA C104/A21.4
CEMENT LINING:	ANSI/AWWA C104.A21.4
EPOXY COATING:	ANSI/AWWA C116/A21.16
BELL SOCKETS:	ANSI/AWWA C116/A21.16
BOLTS:	ANSI/AWWA C151/A21.51 and AWWA C900 Table 2
DEFLECTION:	5° Max
INSTALLATION:	AWWA C600

BELL DIMENSIONS IN INCHES

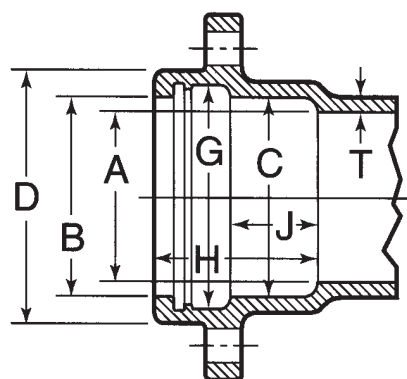

Pipe Size	A	B	C	D	H	J	G	T
4	4.30	4.91	5.04	6.38	4.16	2.25	5.64	.35
6	6.36	7.01	7.14	8.52	4.29	2.25	7.74	.37
8	8.52	9.17	9.32	10.90	4.78	2.25	9.98	.39
10	10.58	11.22	11.37	12.91	4.98	2.25	12.03	.41
12	12.64	13.32	13.47	15.12	4.98	2.25	14.13	.43
14	14.28	15.41	15.64	18.12	5.40	2.25	16.64	.51
16	16.36	17.51	17.74	20.32	5.40	2.25	18.74	.52
18	18.32	19.61	19.83	22.52	5.40	2.25	20.84	.59
20	20.40	21.71	21.94	24.29	5.40	2.25	22.94	.60
24	24.56	25.91	26.14	29.14	5.65	2.50	27.18	.62

Restraining lugs are provided only on sizes 12" and smaller.
Restraining lugs for sizes 14"-24" can be provided given sufficient time to make pattern adaptations. The lug pattern for all sizes accommodate most gripper-type restrainers.