

SUBMITTAL

(Current Revisions for All Standards Apply)

- SIZES:** 2" through 48"
- STANDARDS:** ANSI/AWWA C110/A21.10-08
Note: Cast with tested and traceable ASTM A536 Ductile Iron
- PRESSURE RATING:**..... 2"-48" rated @ 250 PSI
Note: With the use of special flange gasket 2"-24" flanged fittings can be rated @ 350 psi. For 350 psi flange joint applications, we recommend the use of annular ring type gasket or comparable.
- DEFLECTION:**..... Deflection is not recommended for flanged joint fittings due to the rigidity of the joint upon completion of installation.
- NSF-61:** Meets all requirements, UL Certified
- COATING:**..... ANSI/AWWA C104.A21.4-08 Bituminous and Tnemec 140N-1211
- CEMENT LINING:** ANSI/AWWA C104.A21.4-08
- EPOXY COATING:**..... ANSI/AWWA C116/A21.16-09
Note: Epoxy coated fittings are available to the specification(s) required for your application(s)
- BARE:**..... Available
- FLANGES:** ANSI Class 125 B16.1
Note: *ANSI Class 250 B16.1 flanged fittings available
Note: *Due to larger bolt sizing and bolt circle class 250 flanges are not compatible with class 125 flanged fittings.
- FLANGE THICKNESS:** ANSI/AWWA C151/A21.51-05; Standard Class 125 template for drilling bolt holes
Note: Drilling templates are in multiples of 4, so that fittings may be made to face in any quarter. Bolt holes shall straddle the center line.
- BOLTS:**..... ANSI/AWWA C111/A21.11-7
- INSTALLATION:**..... Per AWWA C600-99 using pipe conforming to ANSI/AWWA C151/A21.51-02

FLANGE DETAILS

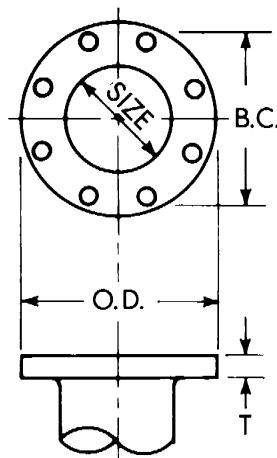

Nominal Pipe Size Inch	Flange O.D.	Dia. of Bolt Circle	Flange Thickness T	Bolt Hole Diameter	Number of Holes	Bolt Dia. & Lengths
2	6	4.75	.62	.75	4	5/8x2 1/4
3	7.5	6	.75	.75	4	5/8x2 1/2
4	9	7.5	.94	.75	8	5/8x3
6	11	9.5	1.00	.875	8	3/4x3 1/2
8	13.5	11.75	1.12	.875	8	3/4x3 1/2
10	16	14.25	1.19	1.00	12	7/8x4
12	19	17	1.25	1.00	12	7/8x4
14	21	18.75	1.38	1.125	12	1x4 1/2
16	23.5	21.25	1.44	1.125	16	1x4 1/2
18	25	22.75	1.56	1.25	16	1 1/8x5
20	27.5	25	1.69	1.25	20	1 1/8x5
24	32	29.5	1.88	1.375	20	1 1/4x5 1/2
30	38.75	36	2.12	1.375	28	1 1/4x6 1/2
36	46	42.75	2.38	1.675	32	1 1/2x7
42	53	49.50	2.62	1.625	36	1 1/2x7 1/2
48	59.50	56.00	2.75	1.625	44	1 1/2x8