

Tyler/Union

C110 FLANGED FITTINGS SUBMITTAL

SIZES:	2" through 48"
STANDARDS:	ANSI/AWWA C110/A21.10
PRESSURE RATING:	250 PSI
NSF-61:	Meets all requirements, UL Certified
COATING:	ANSI/AWWA C104/A21.4 AND Tnemec 140N-1211
CEMENT LINING:	ANSI/AWWA C104/A21.4
EPOXY COATING:	ANSI/AWWA C116/A21.16
BARE:	Available
FLANGES:	ANSI CLASS 125 B16.1
FLANGE THICKNESS:	ANSI/AWWA C115/A21.15; STANDARD CLASS 125 TEMPLATE FOR DRILLING BOLT HOLES

FLANGE DETAILS

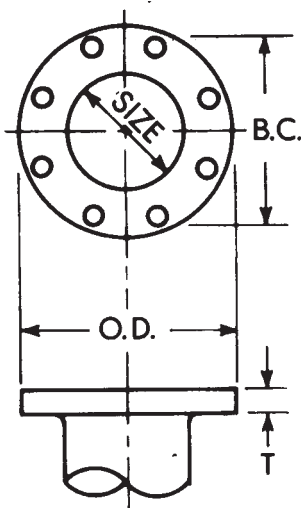

Nominal Pipe Size Inch	Flange O.D.	Dia. of Bolt Circle	Flange Thickness T	Bolt Hole Diameter	Number of Bolts	Bolt Dia. and Lengths
2	6	4.75	.62	.75	4	5/8x2 1/4
3	7.5	6	.75	.75	4	5/8x2 1/2
4	9	7.5	.94	.75	8	5/8x3
6	11	9.5	1.00	.875	8	3/4x3 1/2
8	13.5	11.75	1.12	.875	8	3/4x3 1/2
10	16	14.25	1.19	1.00	12	7/8x4
12	19	17	1.25	1.00	12	7/8x4
14	21	18.75	1.38	1.125	12	1x4 1/2
16	23.5	21.25	1.44	1.125	16	1x4 1/2
18	25	22.75	1.56	1.25	16	1 1/8x5
20	27.5	25	1.69	1.25	20	1 1/8x5
24	32	29.5	1.88	1.375	20	1 1/4x5 1/2
30	38.75	36	2.12	1.375	28	1 1/4x6 1/2
36	46	42.75	2.38	1.675	32	1 1/2x7
42	53	49.50	2.62	1.625	36	1 1/2x7 1/2
48	59.50	56.00	2.75	1.625	44	1 1/2x8

NOTE: Drilling templates are in multiples of four, so that fittings may be made to face in any quarter. Bolt holes shall straddle the center line.